

Day & Night IR Led Bullet Camera

APD-F7Y54HS

www.asungelec.com



Features

- ◆ 1/3" SONY Super HAD II CCD
- ◆ Low S/N IR ON 0.0Lux
- ◆ 6.0mm Standard Board LENS
- ◆ SBLC (Super Back-light compensation)
- ◆ Day & Night Function, 54pcs IR,50M
- ◆ Black or Silver Color Selectable

Option

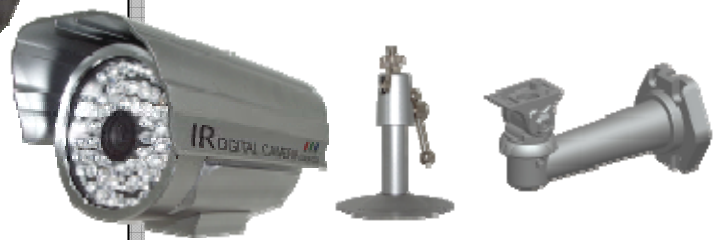

Option

Model	CCD	TV Line
APD-F7Y54HS/B	1/3" SONY Super HAD II CCD	600 TV Line
APD-F7654(H)S/B	1/3" Sony CCD	420 TV Line
APD-F7854(H)S/B	1/3" Sony CCD	520 TV Line

Specification

Model	APD-F7Y54HS	
Signal System	NTSC	PAL
Scanning System	2:1 Interface	
Scanning Frequency(H)	15.734kHz	15.625kHz
Scanning Frequency(V)	59.94Hz	50Hz
Image Sensor	1/3 inch SONY Super HAD II CCD	
Sync. System	INT	
Horizontal Resolution	600 TV Lines (DETAIL ON)	
S/N Ratio	More than 52dB (AGC OFF)	
Lens	6MM / 8MM / 12MM Fixed Lens	
Min. Illumination	0.01 Lux / 0.0 LUX IR ON	
Backlight Compensation	Yes	
White Balance	AWB	
AGC	AGC ON	
IR-LED Q'TY	54 PCS High Sensity IR-LED	
Visual Distance	50 Meters	
Supplied Voltage	DC12V 90mA (570mA IR ON)	
Video Output	VBS 1.0 Vp-p (75 ohm Load)	
Operating Temp.	-10°C to +55°C	
Storage Temp.	-20°C to +70°C	
Dimension	83.2 X 86.2 X 152(mm)	
Weight (Net)	0.5Kg (0.8Kg include as-155 bracket)	

Drawing(mm)

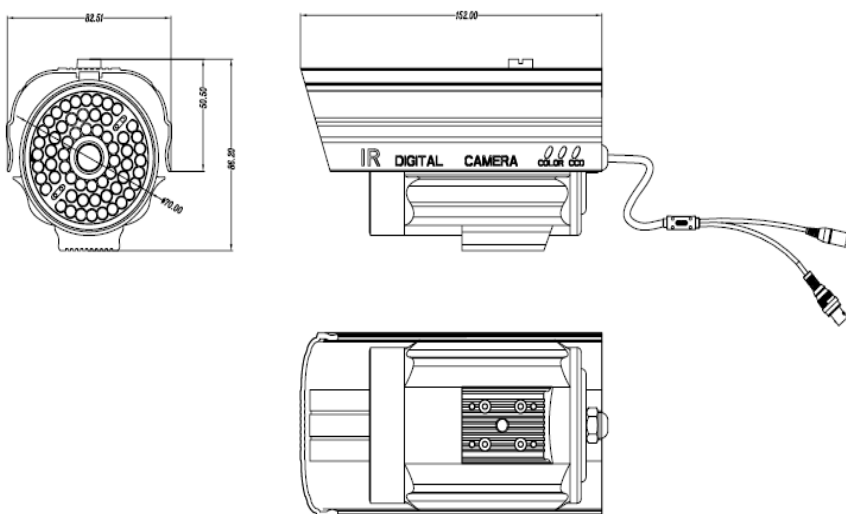

146.00

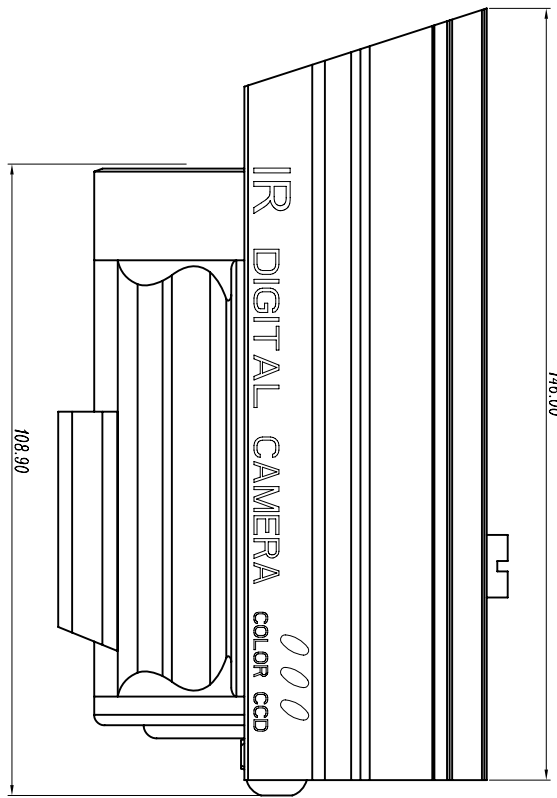

108

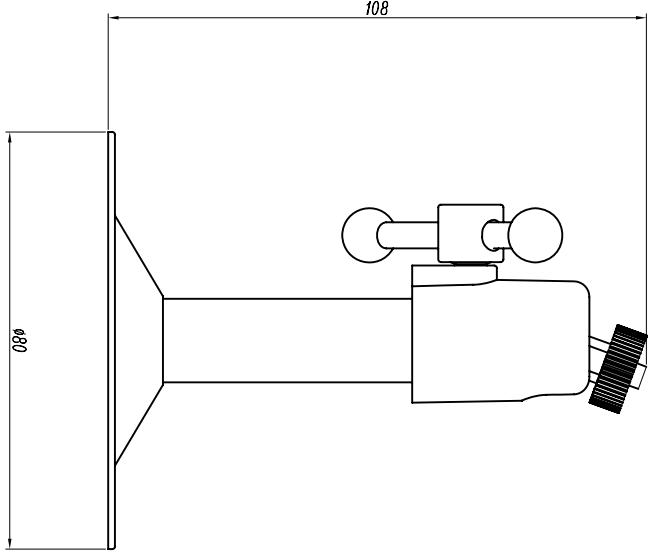

68.0

000

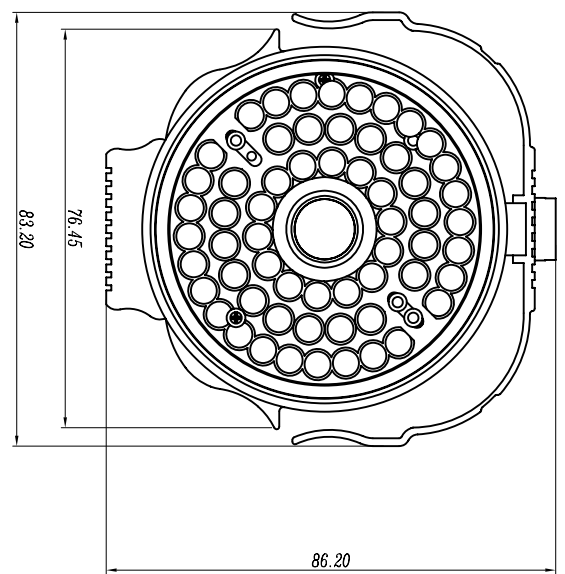
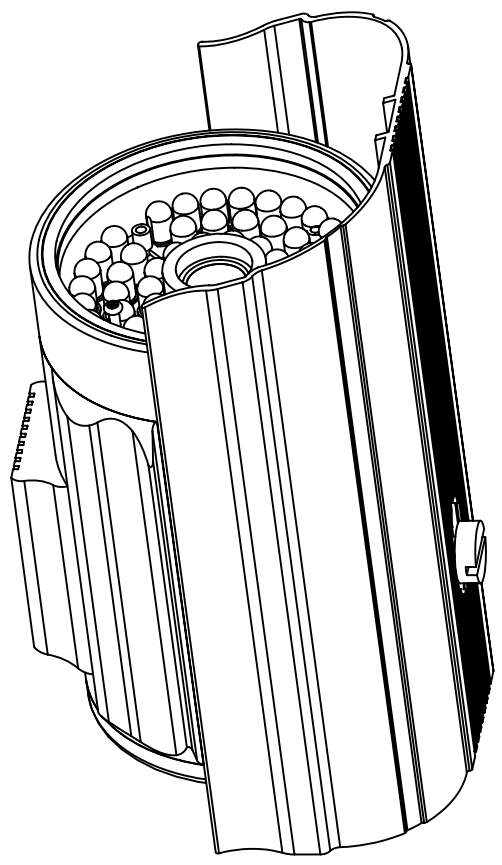

86.20

76.45

83.20

User Manual

IR LED COLOR BULLET CAMERA

(APD-F7Y54HS)

1. CAUTION.



*Don't place this product under extreme temperatures (Suitable temp range: 0°C~40°C)

*Don't use this product near water or moisture.

*Don't use liquid cleaners or aerosol cleaners.

*Don't place this product on an unstable cart, stand or table.

2. FEATURE & FUNCTION.

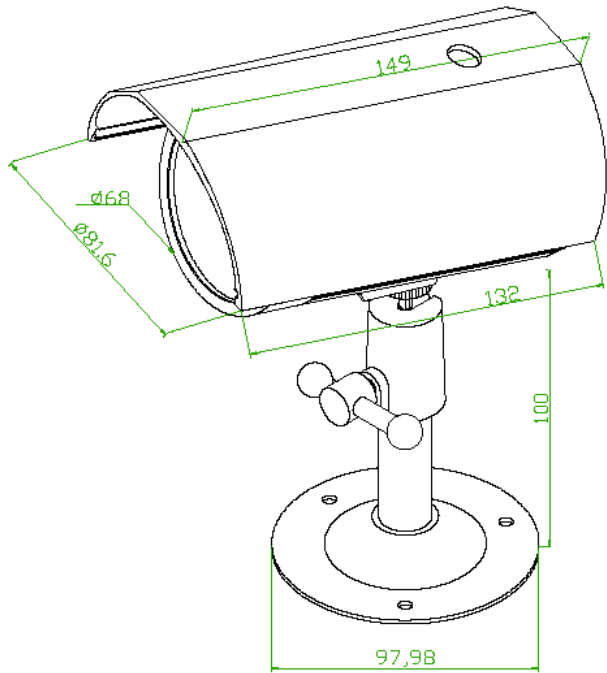

Feature

■ Reliability – With the use of high quality parts and durable CCD, a long trouble-free operation of the camera is assured.

■ Super Compact – Even an epochal small size in color camera it has perfect weatherproof function, clear color picture, reasonable price impressing you.

■ Shock Resistant – High quality PCB with the new high tech surface mounting technology insures resistance from shock as well as vibration.

■ Easily mounted – The module comes equipped with mounting holes on the PCB allowing easy mounting to any type of casing. One-piece real compact board with flexibility can be fit any casing.

■ Connectivity – You can have nice picture through BNC or RCA phone cable which we provide with this camera and you can use simple AC adpoter for power supply by AC jack on this camera.

■ 1/3 " SONY Super HAD II CCD

■ IR-LED control by CDS sensor

■ 0 Lux at IR LED ON

■ Lens changeable
– 4.3mm, 6mm, 8mm and 12mm

■ Weatherproof

3. Installation.

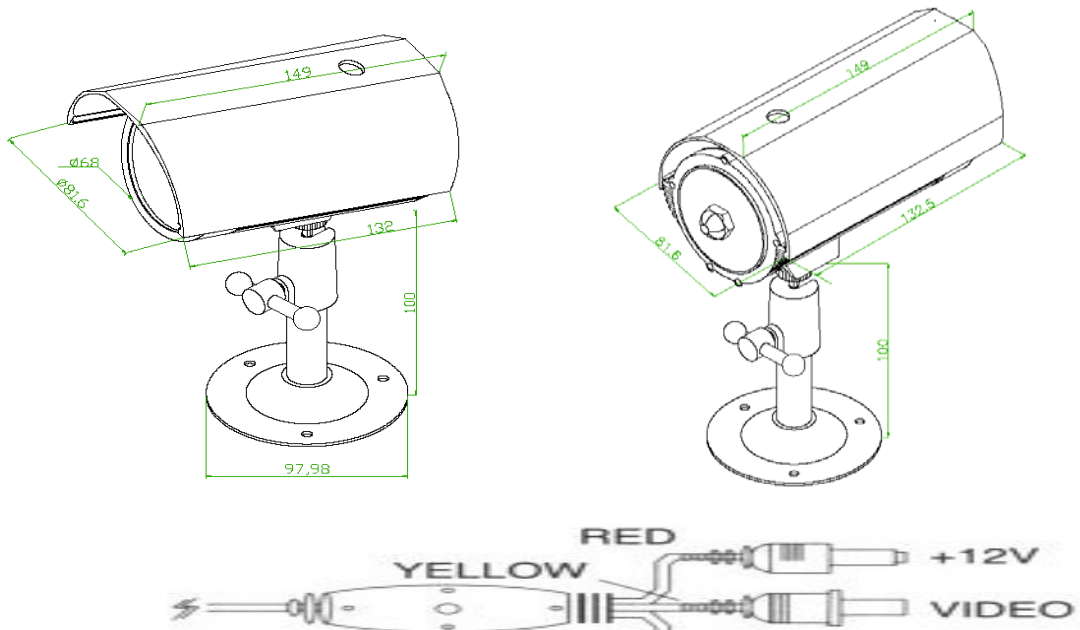

The image contains three technical drawings. The top left drawing shows a side view of the camera with dimensions: length 149, diameter 46.8, mounting hole diameter 82.5, mounting hole offset 132, mounting hole diameter 97.98, and mounting hole offset 100. The top right drawing shows a front view of the camera with dimensions: length 149, diameter 81.6, mounting hole diameter 132.5, and mounting hole offset 100. The bottom drawing is a wiring diagram showing a power supply connected to a yellow wire (labeled 'YELLOW'), a red wire (labeled 'RED'), and a video cable (labeled 'VIDEO'). A '+12V' label is also present.

- There are three mounting holes on the bracket so that users can install the unit in any place such as on the ceiling,
On the wall, on the fence and etc..
- Fix the camera on the bracket.
- Please check the points below before connecting video & power cable.
 - Power supply.
 - * Adaptor : DC12V/1,000mA
 - *To avoid fire or shock hazard, must use a UL listed power supply.
 - Monitor Impedance.
 - *Set the impedance switch to 75ohm standard position.
 - *When monitor is set to high impedance mode, the picture becomes blurred.
 - In this case, just check the position of the monitor impedance switch.
- Adjust picture direction pan & tilt

Caution! To avoid smear, never face the camera directly to the strong light source such as sun or spot light.

4. Specification.

spec.	APD-F7Y54HS			
Horizontal resolution	600TV Line	Input voltage	DC 8.0 to 18.0 V	
Pick-up device	1/3" Sony interline CCD			
Synchronization	Internal	Power Consumption	120mA(DC12V)/560mA at IR LED ON (DC12V)	
H-Aperture	Yes			
IR LED	54pcs	Temperature	Operating	-10℃ to +55℃
Auto Iris	1/50 - 1/100.000		Storage	-20℃ to +70℃
AE/ME	Off	humidity	Operating	Under 90% Non-condensing
BLC	Off		Storage	Under 95% Non-condensing
Light sensitivity	0Lux	AGC	On (4-26dB Max)	
Signal to Noise Ratio	>46dB	White Balance	Auto white balance	
Gamma	0.45	Size/weight	70 diameter/1,200g	



Asung Electronics Ind. Co., Ltd.
 3F, EOEUN BLDG, 85, MUNJEONG-DONG, SONGPA-GU, SEOUL, KOREA
 TEL. : 82-2-443-9702(REP.) FAX : 82-2-448-5750
 Web site : www.asungelec.com E-MAIL : sales@asungelec.com